

TECHNICAL DATA SHEET

RADIAL FAN nr. AFGG-25_24



G&G filtration CZ, s.r.o.

A Hrubínova 1903/9, 66451 Šlapanice, CZ
 IČ 05226953 IČ DPH CZ05226953
 E info@ggf.cz W www.ggf.cz

ITEM1

Document printed by Aeraulica - Dimensions and performances can be changed without prior notice

Type and characteristics of the requested machine				performance on		Outlet		
Flow rate	60000 [m3/h]	Capacity (Normal)			55907 [Nm3/h]			
Total pressure	2500 [Pa]	Static pressure						
Working fluid temperature	20 [°C]	Fluid specific weight			1.204 [Kg/m3]			
Installation altitude	0 asl [m]	Specific weight std (20 [°C], 0 asl [m])			1.204 [Kg/m3]			
Suggested model and effective characteristics				performance on		Outlet		
Model	RL 1250/6-I	Execution	E04	Installation Type	A (free inlet and outlet)			
Fluid specific weight	1.204	1.204 [Kg/m3]		Revolution fan speed		985 [rpm]		
Total pressure	2599	2599 [Pa]		Orientation		RD 0		
Static pressure	2470	2470 [Pa]		Sound power LwA		105.07 [dB(A)]		
Flow rate	60000	60000 [m3/h]		Sound pressure at mt.1.5 1/2 sf in open field		91.77 [dB(A)]		
Capacity (Normal)	55907	55907 [Nm3/h]		Pipings	s>3mm = +3dB; 1mm<s<3mm = +4,5dB ; s<1mm = +6dB			
Power dem. at shaft	52.471	52.471 [kW]		Fan efficiency	Outlet	82.55 %		
Motor power demand	52.471	52.471 [kW]						
Characteristics of chosen motor				Motor efficiency IEC 60034-30			PD ² impeller	
Code	315S06-50/std3P	shape	B3	Efficiency	94.6	94.9	94.4	240.0 kgm ²
Rated power	75.0 [kW]	n° poles	6	rpm	990	Load	100%	75%
							50%	PD ² needed 237.58 kgm ²
								PD ² motor 630 kgm ²
ErP 2009/125/CE Regulament (UE) N. 327/2011				Notes				
Efficiency grade	64			N	77	Total efficiency	78.91	%
Impeller type	backward blades	Type of test	B/total	Flow rate	66810 [m3/h]	Pressure	2311 [Pa]	
NOTE	Performance on Outlet RL 1250/6-I - E04 - D=1.25[m] - ρ=1.204[kg/m ³] - T=20[°C] - 0[m]a.s.l.							
Rpm Limit	<=60 °C: 1100 Rpm							
values of the noise of fan obtained in ambient not reverberant with inlet and outlet ducts fully insulated								

TECHNICAL DATA SHEET

RADIAL FAN nr. AFGG-25_24



G&G filtration CZ, s.r.o.

A Hrubínova 1903/9, 66451 Šlapanice, CZ

IČ 05226953 IČ DPH CZ05226953

E info@ggf.cz W www.ggf.cz

ITEM1

Document printed by Aeraulica - Dimensions and performances can be changed without prior notice

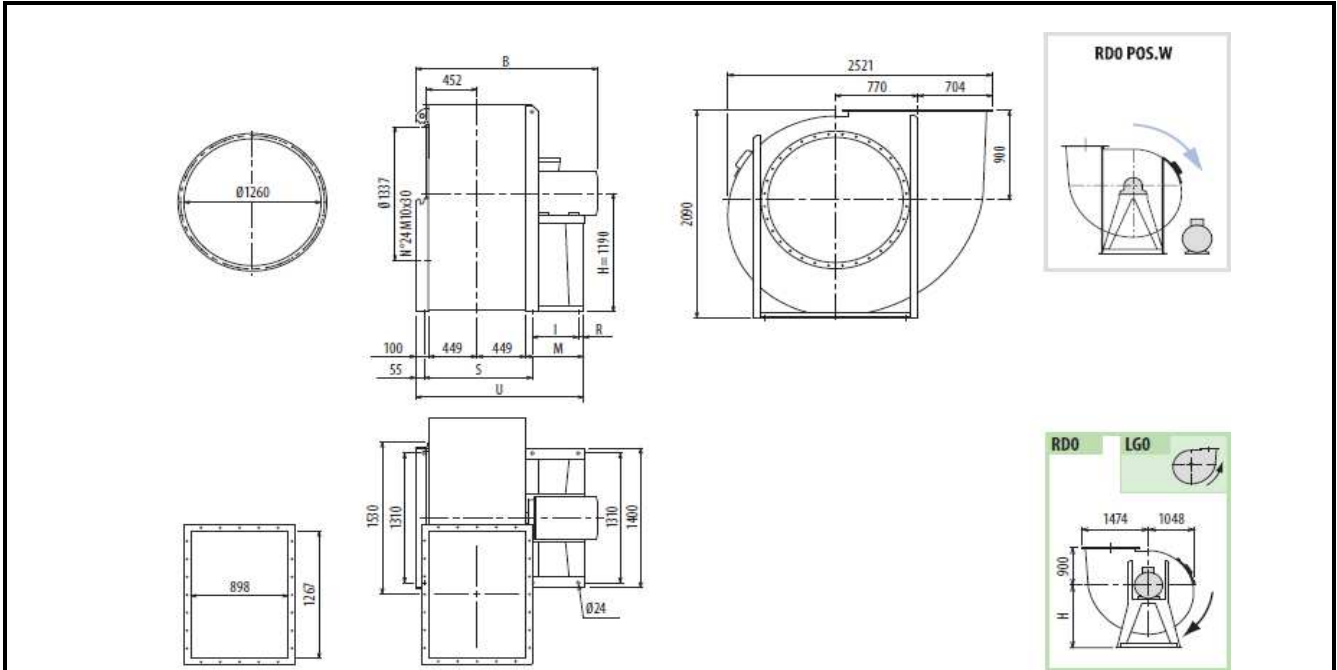

Indicative measures in the standard configuration. For detailed information contact your reference.

Indicative value of weight including standard motor.

B	I	H	H1	H2	M	R	S	U	PD2	kg
2030	675	1190	900	1500	800	45	1023	1798	240	1960

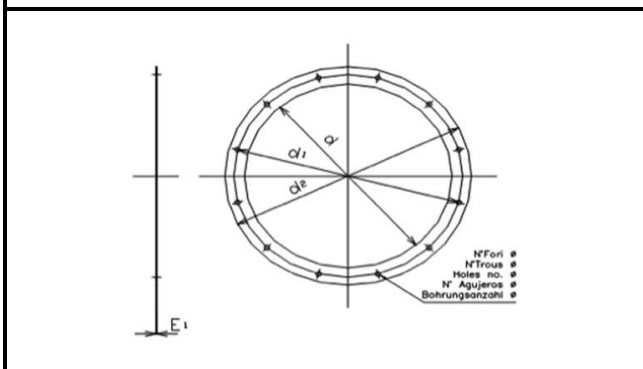

Cod	dxn°	d1	d2	Φ	E1
1260 A	1260x24	1337	1380	17	6

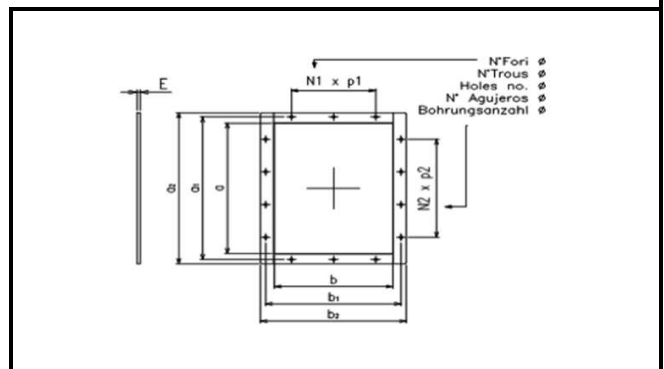

Cod	axb	a1	b1	a2	b2
1267x0898	1267x898	1347	978	1407	1038

N1xp	N2xp	n°	Φ	E
4x200	6x200	24	18	8